

# flip | nest

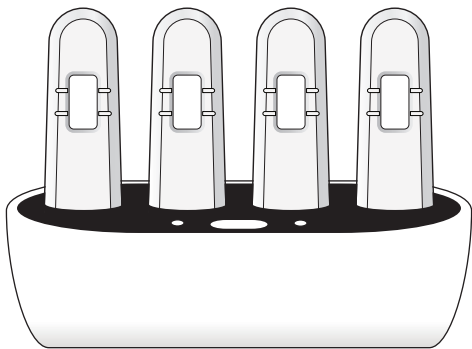

## Instructions

Product Code: FPR001-0029

Document Reference: FPR001-0050 v1.0

## In the box:

1 x Flip Nest

1 x USB-C power cable

1 x Instructions

## Overview:

Button

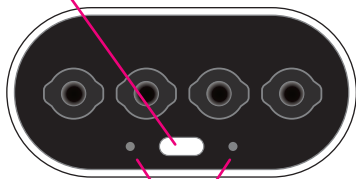

Feedback Lights

The Flip Nest is manufactured in the UK  
by Fuse Diagnostics Ltd.

## Intended Use

The Flip Nest is intended solely for the purpose of incubating Flip tests during the performance of the test and according to the test instructions. It is not intended for any other purpose.

## Technical Specification

The Flip Nest is a controlled electronic heating device capable of heating up to 4 Flip test devices simultaneously to their incubation temperature of 50°C.

The device is designed to be connected to a USB power source via its USB-C port, it does not transmit or receive any data.

The heater runs continuously when the device is plugged in. Unplug the Flip Nest when not in use.

The device has a manually operated electronic timer that will output an audible and visual alarm 10 minutes after activation to alert the user that the incubation time is complete.

## Product Code: FPR001-0029

Rated Power	5V DC, 0.9A
Size	96mm x 48mm x 35mm
Weight	65 grams
Connections	USB-C (Power Only)

**Read all steps before use**

1

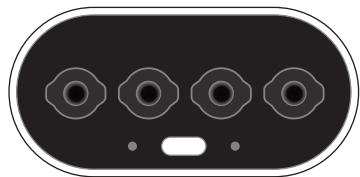
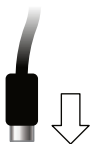

Plug the Flip Nest into a USB port using the supplied cable.

2

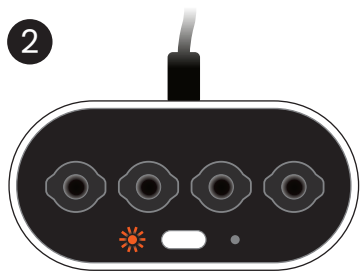

The left LED light will pulse orange to show the Nest is warming up.

3

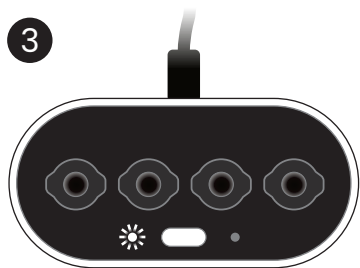

When it is ready the Nest will beep and the light will go solid white.

4

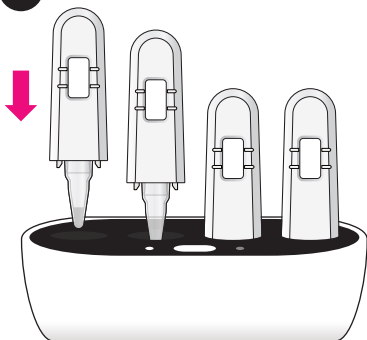

Place prepared Flip tests into the preheated Nest. Up to 4 tests can be run at once, if you are running multiple tests prepare all tests immediately prior to placing them in the nest.

5

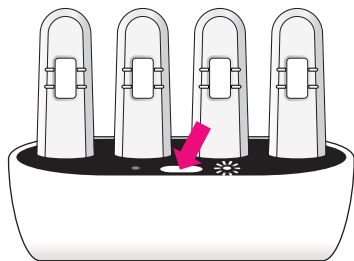

Press the button to start the 10 minute timer. The LED lights will pulse alternately while the timer is running.



When it is plugged in the Nest remains at incubation temperature. Tests should only be placed into the Nest when ready and should be removed immediately when the incubation is complete.

6

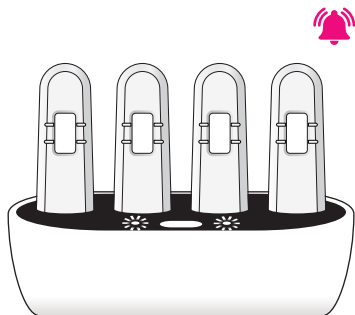

After 10 minutes the Nest will sound an alarm and the lights will flash to indicate the time is complete. Press the button to cancel the alarm.

7

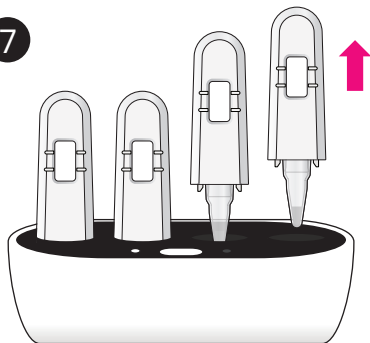

Immediately remove the Flip tests from the Nest and continue according to the test instructions.



If you need to cancel and reset the timer press and hold the button. The Nest will give a long beep and then a double beep to indicate it has reset.

5

## **Use Environment**

The Flip Nest is designed to operate indoors and at room temperature (15°C - 30°C). The device is not designed to be waterproof or splash proof and should be kept dry at all times.

## **Cleaning**

The outer surfaces of the device can be wiped clean. Do not use solvents or harsh chemical cleaners. Do not spray liquid detergents onto the device.

## **Trouble Shooting**

If the Flip Nest is plugged in but does not show any light or is showing a red light then there is an issue with the device. Ensure the cable is fully inserted and/or try connecting the device to a different USB socket.

If this does not resolve the issue please email [info@fuse-dx.com](mailto:info@fuse-dx.com) for further assistance.

## **Disposal**

This equipment is subject to the requirements of the WEEE Directive. The symbol of the crossed-out wheeled bin indicates that the product must not be disposed of as unsorted municipal waste. Disposal of this equipment should be handled through designated collection facilities for appropriate treatment and recycling.



**Fuse Diagnostics Ltd**

10A Harding Way

St Ives

Cambridgeshire

PE27 3WR

[info@fuse-dx.com](mailto:info@fuse-dx.com)

[www.fuse-dx.com](http://www.fuse-dx.com)

[www.flip-dx.com](http://www.flip-dx.com)

FUSE™ and FLIP™ are trademarks of Fuse Diagnostics Limited.

© 2025 Fuse Diagnostics Ltd. All Rights Reserved